

INSTRUCTION MANUAL



SMART ALERT POWER FILTER 400 / 800 / 1200

Thanks for purchasing our product. To ensure you to use the product safely and correctly, please read this instruction carefully and thoroughly.

Please note that we are not responsible for any failure caused by misuse or improper maintenance. Save this instruction for future reference.

WARNING: To guard against injury, basic safety precautions should be observed, including the following:

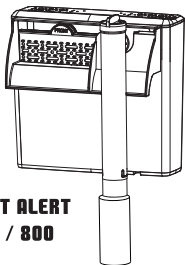

**SMART ALERT
400 / 800**

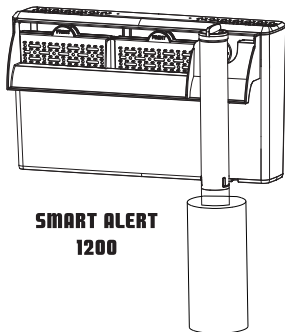

**SMART ALERT
1200**

READ AND FOLLOW ALL SAFETY INSTRUCTIONS

DANGER: To avoid possible electric shock, special care should be taken since water is involved in the use of aquarium equipment. For each of the following situations, do not attempt repairs by yourself; return the appliance to an authorized service facility for service or discard the appliance.

1. Carefully examine the appliance after installation. It should not be plugged in if there is water no parts not intended to be wet.
2. Do not operate any appliance if it has a damaged cord or plug, or if it is malfunctioned or has been dropped or damaged in any manner.

3. To avoid the possibility of the appliance's plug or power outlet getting wet, position the aquarium stand and tank to one side of power outlet to prevent water from dripping onto the power outlet or plug. A drip-loop should be arranged by the user for each cord and connecting an aquarium appliance to a power outlet. The drip-loop is that part of the cord below the level of the power outlet, or the connector if an extension cord is used, to prevent water traveling along the cord and coming in contact with the power outlet. If the plug or power outlet does get wet, DO NOT unplug the cord. Disconnect the fuse or circuit breaker to that appliance. Then, unplug and wipe away any water.
4. Close supervision is necessary when any appliance is used by or near children.
5. To avoid injury, do not contact moving parts or hot parts.
6. Always unplug an appliance from a power outlet when not in use, before putting on or taking off parts, and before cleaning. Never yank the cord to pull plug from outlet. Grasp the plug and pull to disconnect.
7. Do not use an appliance for other than its intended use. The use of attachments not recommended or sold by the appliance manufacturer may cause an unsafe condition.
8. Do not install or store the appliance where it will be exposed to weather or to temperatures below freezing point.
9. Make sure an appliance mounted on an aquarium tank is securely installed before operating it.
10. Read and observe all the important notices on the appliances.
11. If an extension cord is necessary, a cord with a proper rating should be used. A cord rated for less amperes or watts than the appliance rating may overheat. Care should be taken to arrange the cord so that it will not be tripped over or pulled accidentally.
12. For some countries, this appliance has a polarized plug (one blade is wider than the other). As a safety feature, this plug will fit in a polarized outlet only one way. If the plug does not fully fit in the outlet, reverse the plug. If it still does not fit, contact a qualified electrician. Never use with an extension cord unless the plug can be fully inserted. Do not attempt to override this safety feature. This appliance has no user-serviceable parts.
13. A 10mA or 30mA residual current device must be fitted to the main supply.
14. If the filter makes an unusual sound or smell, unplug it immediately and check the cause. Contact your retailer / distributor if needed.
15. Remove and replace the filter if it becomes damaged.
16. Do not let the filter run dry as this will damage the motor due to overheating.
17. Do not operate or leave the filter in freezing conditions.
18. Always keep the filter system clear of debris. If it becomes clogged, the flow rate will decrease, and the impeller will stop working.
19. Do not use the filter in flammable or corrosive liquids. The filter should work in a water environment less than 90°F (32 deg C).

Product Feature

- Indicator design. The LED light turns red to remind users when it's time to change the filter cartridge.
- Powerful 3-stage filtration system, including mechanical, biological, and chemical processes, ensures to clean and healthy water.
- The extendable intake tube and adjustable flow rate ensure the filter operates effectively under various conditions.
- Whisper-quiet operation.
- Easy to install and maintain. Users can replace the filter cartridge every 3-4 weeks for optimal performance.

Save the instructions

Components:

- Open the package and check if there is any visual damage to the filter.
- Check if the filter cartridges and water pump are installed properly.

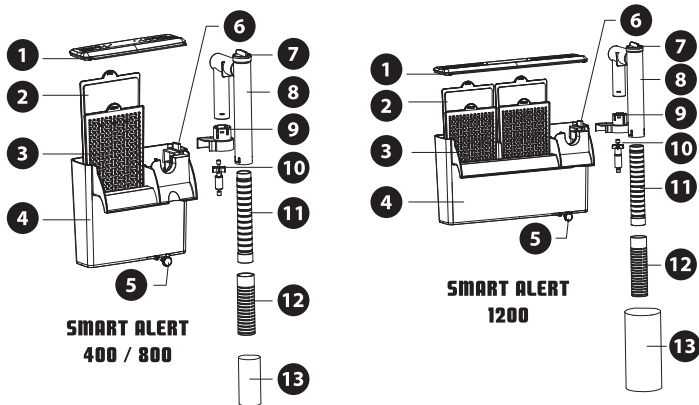

1. Cover

2. Mechanical and Chemical Filter Cartridge

3. Biological Substrate Filter Cartridge

4. Filter Body

5. Leveling Knob

6. Cartridge Replacement LED Indicator

7. Flowrate Adjustor

8. Intake Tube

9. Impeller Cover

10. Impeller

11. Extension Tube

12. Strainer

13. Pre-filter sponge

Assemble Intake

- Attach the pre-filter sponge to the strainer.
- Attach the strainer to the extension tube.
- Attach the extension tube to the water intake tube.
- Insert the impeller assembly into the impeller cover, then connect it to the elbow end of the intake tube.
- Insert the impeller assembly (already connected to the intake tube assembly) into the filter compartment. Press down to ensure the entire intake tube is securely fitted in place.

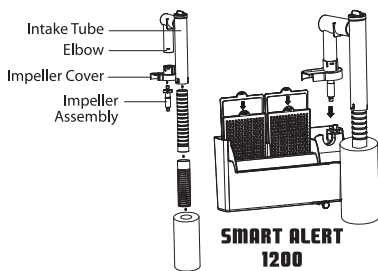
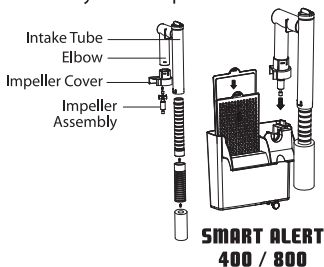

Install & Fill

- Hang the power filter on the back of the aquarium tank.
- Adjust the filter leveling knob to the proper position by turning it as needed.
- Extend the water intake tube down towards the top of the gravel line.
- Fill the filter compartment with water (**VERY IMPORTANT!** Failing to do so will cause unusual noises).
- Connect the filter to the power supply.

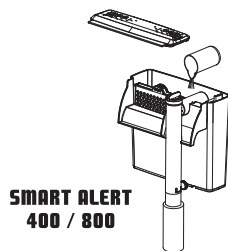

Pour water into the filter compartment until it's full.

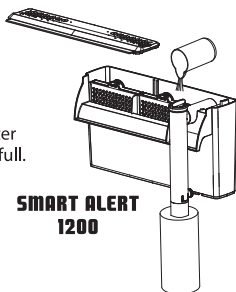

Reminder

Unusual noises may occur when you first power up the filter due to air pockets in the intake tube. Make sure the filter compartment is filled with water and allow a few cycles for the filter to achieve quiet operation.

Replace Filter Cartridge(s)

1. To get the best filtering efficiency, it is suggested to replace the Mechanical and Chemical filter cartridge every 3-4 weeks.
2. To replace the cartridge, follow these steps:
 - Unplug the power supply.
 - Adjust the flowrate to the minimum and remove the filter cover.
 - Take out the power filter.
 - Pour out the dirty water from the filter compartment.
 - Rinse the new cartridge with clean water and insert it into the filter. Ensure the tab on the filter cartridge is facing upwards!
 - Adjust the flowrate back to the maximum position.

If the indicator light flashes red or turns solid red, the cartridge needs to be replaced or cleaned.

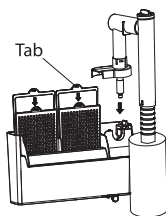
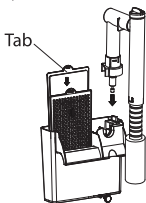
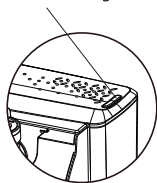

Troubleshooting

Failures	Possible solutions
The filter fails to pump water or has reduced flow.	<ol style="list-style-type: none">1. Check that the power outlets are working. Unplug and re-plug it to restart the water pump.2. Check and ensure the impeller assembly is securely placed in the filter compartment.3. Remove the impeller assembly and check that the impeller can rotate freely. Clear any debris like carbon or gravel.4. Check the aquarium's water level; it should be 1/2 inch below the top of the frame.5. Clean the inside of the water intake tube.
The filter is unusually noisy.	<ol style="list-style-type: none">1. Ensure the filter compartment is filled with water.2. Check and ensure the impeller assembly is securely placed in the filter compartment.3. Remove the impeller assembly and check that the impeller can rotate freely. Clear any debris like carbon or gravel.4. Replace any worn parts in the impeller assembly.
There is air trapped in the system.	Check the water intake tube assembly for cracks and replace it if it's damaged.

Maintenance

Change the filter media

The filter cartridge will get dirty. Change the cartridge every 3-4 weeks.

Maintaining proper water quality is an important part of fish keeping.

Without clean water, fish can become stressed and more susceptible to diseases and parasites.

Follow these water care guidelines to keep your fish and aquarium healthy:

- Chlorinated tap water is toxic to fish. Make water safe with water conditioners and beneficial bacteria:
- Water conditioners and beneficial bacteria are needed for new aquarium setup.
- Water conditioners remove harsh chemicals (Chlorine) and minerals from tap water.
- Beneficial bacteria boost healthy levels of good bacteria to remove harmful ammonia and nitrites.

Keep your fish and aquarium healthy by testing the waters:

- Test water every 1-2 weeks to monitor aquarium health.
- Partially change water every 2-4 weeks to keep it balanced.

After you have properly set up your aquarium and established good water quality, follow these steps:

- Only add about three new fish at a time.
- Take fish home immediately after purchasing.
- Float the sealed bag of fish in the aquarium tank for about 15 minutes to balance the water temperature.
- Carefully add the fish to their new home and be careful to avoid adding water from the bag to the aquarium.
- Feed the new fish 1-2 hours after adding them to their new home.
- Don't overfeed your fish! It's one of the most common mistakes.



Another quality product from:

Yi Hu Fish Farm Trading

(a subsidiary of Qian Hu Corporation Limited)

71, Jalan Lekar, Sungei Tengah, Singapore 698950.

✉ yihufish@qianhu.com | www.yihufish.com