



Hydra

AQUATIC DEPURATOR
NANO PLUS

- Breaks Down Protein and Nutrients
- Detoxify Ammonia (NH₃) & Nitrite (NO₂-)
- Create and Maintain Safe and Stable Pristine "Hydro-Pure Water"
- Marine & Freshwater
- Built-in Surface Skimmer

Instruction Manual

1. Introduction

OF® Hydra Nano Plus is designed to help nano-aquarium enthusiasts achieve the best water conditions. It is powered by Hydro-Pure Technology which helps to break down Protein and Nutrients, detoxify Ammonia (NH₃) & Nitrite (NO₂-), thus creating and maintaining safe and pristine water conditions, also known as the "Hydro-Pure Water".

The Hydra Nano Plus also has a surface skimming function that removes unsightly surface film caused by buildup of dirt, protein and microorganism. The result is a crystal clear water surface which helps to improve oxygen exchange and increase light penetration at water surface. It can be easily converted to function as an internal filter or a low water level turtle tank filter, making it a truly versatile water depurating device.

2. The Working Principle of Hydro-Pure Technology

Hydro-Pure Technology is a patented water detoxifying and depurating technology for applications in both Marine and freshwater Aquatic Hobby. It consists of two electro-plates to energize a cartridge box containing special Cata-pure Catalyst Media to generate strong reactive Hydroxyl radicals (.OH), which is the key to the detoxifying and depurating reactions process.

Hydro-Pure Technology creates safe and stable pristine "Hydro-Pure Water" similar to that of natural river stream rich in micro nutrients and minerals. Hydro-Pure Technology is suitable for marine and freshwater fish tanks of all sizes, all types of fishes, plants and live corals and all levels of stocking density. It also helps in the prevention of "New Tank Syndrome" especially in Marine tanks application. Also suitable for all applications that requires pristine water condition of safe and stable level of Ammonia, nitrites and nitrates acceptable for aquatic life.

3. Features

i) Hydra Nano Plus is powered by Hydro-Pure Technology which constantly breaks down Protein, detoxifies Ammonia (NH₃) and Nitrite (NO₂-), reducing overall level of organic nutrients much faster than normal biological filtration which results in biologically clean and safe pristine water quality for your fishes. This greatly reduces the frequency of water change.

ii) Hydra Nano Plus features a surface skimmer that automatically adjusts itself to function even with changes in water level (up to 30mm) caused by evaporation. It removes unsightly surface film caused by buildup of dirt, protein and microorganism, to achieve crystal clear water surface.

iii) The Skimmer-Inlet Sieve prevents small fish or shrimp from being sucked in into the unit, making it an ideal product for raising fish and shrimps.

iv) Just by changing the fittings, Hydra Nano Plus can be converted from a surface skimmer into an internal depurating filter or a low-water level filter for your turtle tank.

4. Specifications

OF® HYDRA NANO PLUS					
Model	Flow Rates	Suitable Tank Sizes	Power	Cata-pure	Product Dimension (L*W*H mm)
HYDRA NANO PLUS	300 L/H	<50 L	5W	1pc	50*77*178

5. Installation Guide

Filling your aquarium to your preferred water level before installation will give you a better indication of where to position the Hydra Nano Plus unit.

- Using Hydra Nano Plus with the Surface Skimmer function:
 - Install the unit in the water at a depth whereby the Skimmer Inlet becomes fully extended (max. 3.5cm). This offers sufficient provision for any changes in water level caused by evaporation.
 - Once the position is determined, use suction cups to secure Hydra Nano Plus to the inner glass surface of your aquarium.

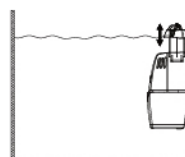

- Using Hydra Nano Plus ONLY:
 - Remove Surface Skimmer Fittings and cover the hole with the Filter Body (Top) Cover.
 - Invert the unit as shown for better filtration results.

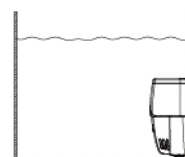

- Using Hydra Nano Plus with venturi effect:
 - Install the Venturi Hose to the Outlet.
 - The Venturi Hose helps to draw air from the surrounding into your water which helps to increase the dissolved oxygen level of your aquarium, keeping your fish healthy and lively.
 - Invert the unit as shown for better filtration results.

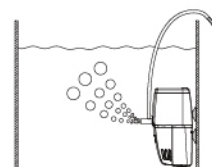

- Using Hydra Nano Plus in low water levels (e.g. Turtle Tanks):
 - Use the Filter Body (Top) Cover to cover the hole in Filter Body (Top).
 - Assemble the Periscopic Pipe Sprout, 'O' Ring and Periscopic Adaptor.
 - Attach the assembled Periscopic Pipe Fitting to Filter Body (Bottom).
 - The waterfall-style water discharge can beautify your aquarium while keeping the water clean.

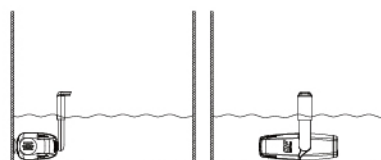

- Once the position is determined, use suction cups to secure Hydra Nano Plus to the inner glass surface of your aquarium. To enhance the suction, please ensure that your glass surface is clean.
- Plug in the power cord; please create a drip loop to prevent water that is running down the power cable from reaching the power plug.
- Ensure that the appliance is properly secure before turning the power on.

6. Maintenance Guide

i. To remove the Filter Body (Top), unlock the catch by gently pushing the Filter Body backward in direction shown, and pull it out.



ii. Remove the sponge filter and rinse it with clean water to remove the accumulated dirt.

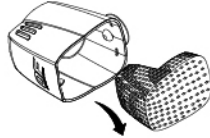

iii. Remove the Cata-pure Nano Cartridge from the Filter Body (Bottom) and rinse it with clean water to remove the accumulated dirt.

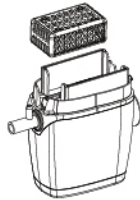

iv. Remove the Pump Cover from the Filter Body (Bottom) and it will reveal the impeller.

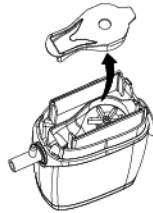

v. Remove the impeller and rinse it with clean water to remove the accumulated dirt and sludge.

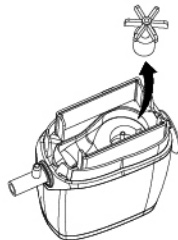

7. Safety Instructions

- This product is limited to indoor use, please do not use the appliance for any purpose other than that for which it is intended.
- Inspect the appliance properly before use; do not operate any appliance if it has a damaged or frayed cord/plug, or if it is damaged in any manner.
- Ensure close supervision when appliance is used in areas easily accessible by young children. This appliance is not intended for use by young children without supervision by adults.
- Always disconnect the appliance from the electrical outlet when not in use or before cleaning or maintenance.
- Regular maintenance routine of inspecting and cleaning the impellor and impellor-inlet is recommended to maintain high performance and to prolong the appliance's lifespan.

8. Exploded View

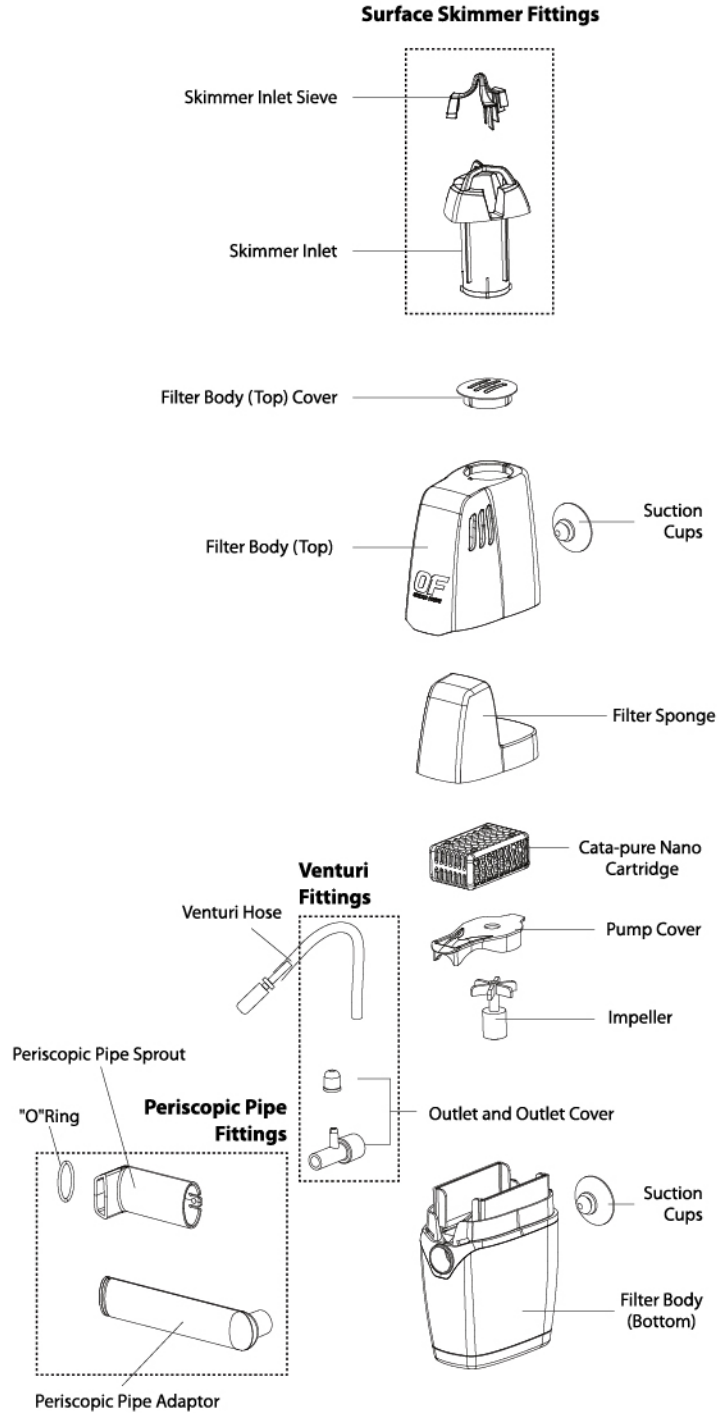

Another quality product from:
Yi Hu Fish Farm Trading
 (a subsidiary of Qian Hu Corporation Limited)
 71, Jalan Lekar, Sungai Tengah, Singapore 698950.
 Fax: (65) 67647077 e-mail: yihufish@qianhu.com